

Gingerbread House Construction

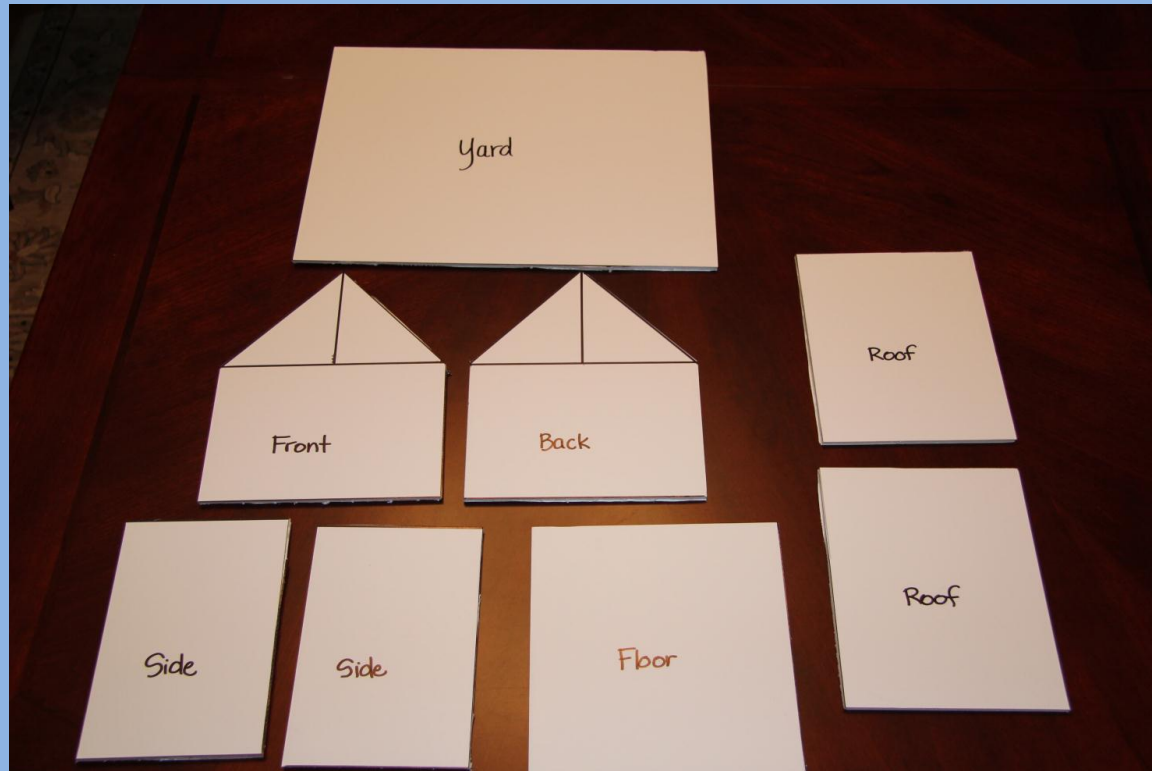

This is a family project. Please work on this with your child and have fun!

Measure twice, cut once! Be sure to label each piece. Once the pieces are cut, they can look similar.

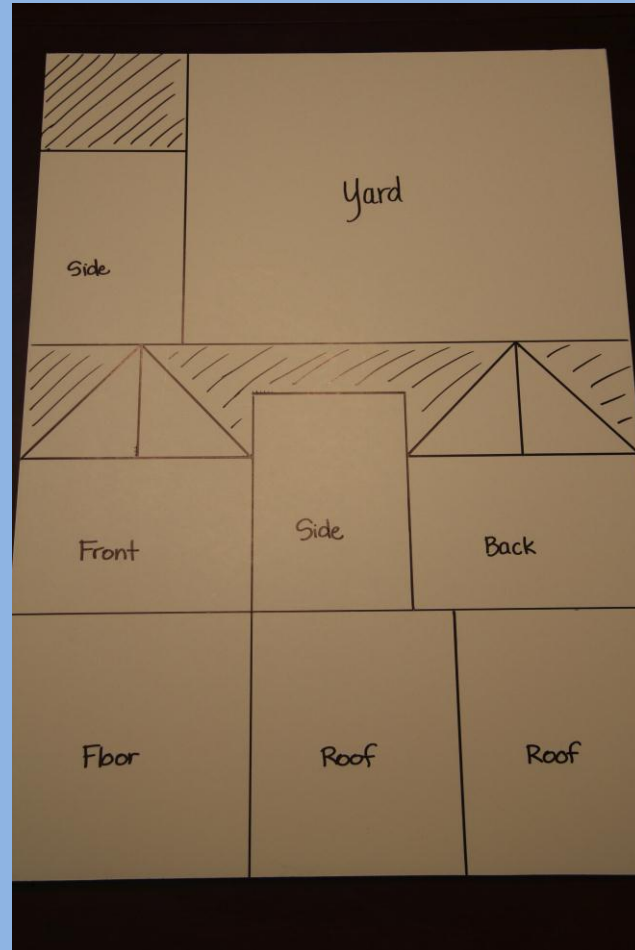

Do you have the seven pieces that are needed to construct the house? Do you have the extra piece for the yard?

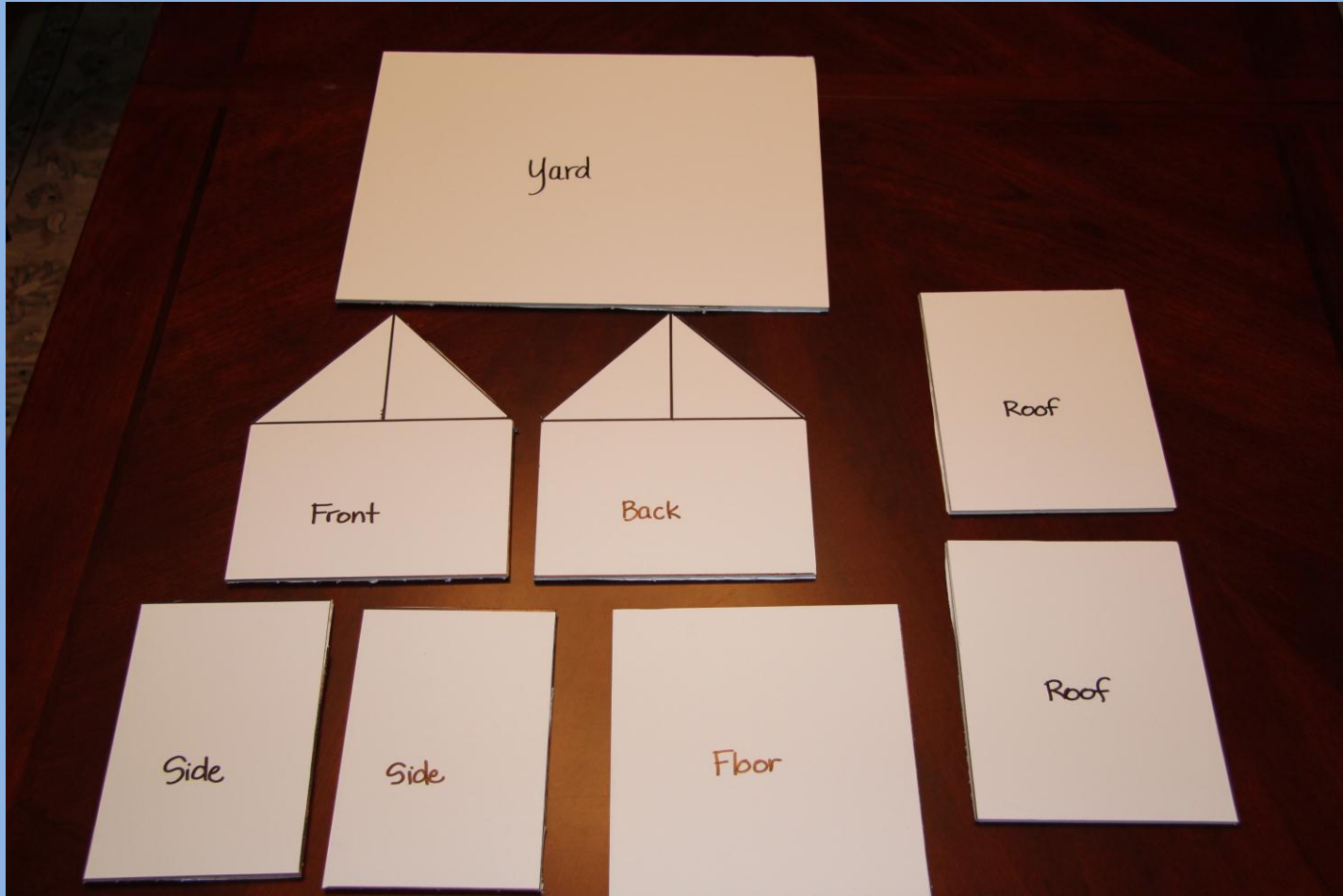

Use regular masking tape to join the pieces of the house together. You can use other types of tape if you choose as well.

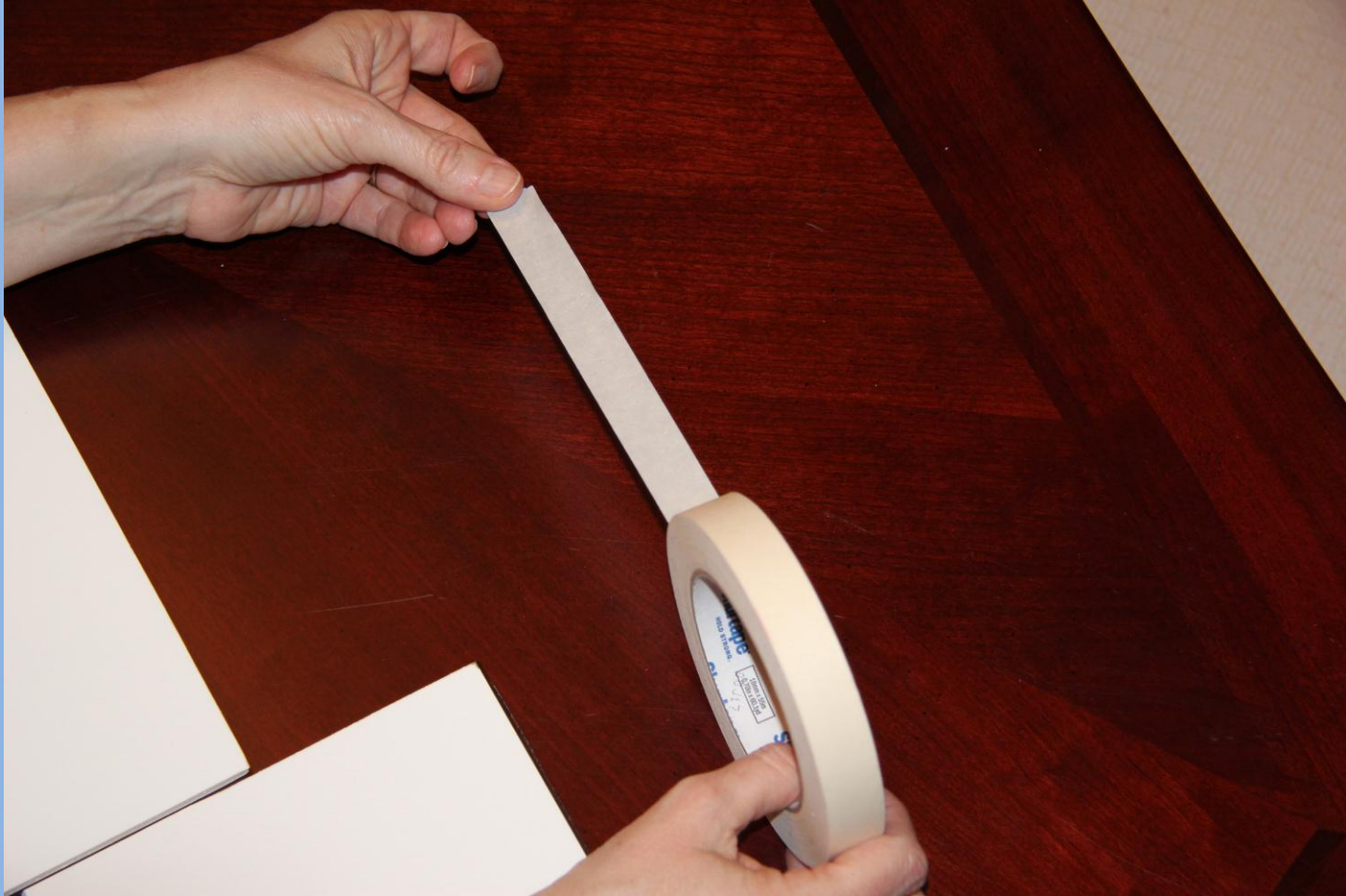

Have plenty of tape ready to go!

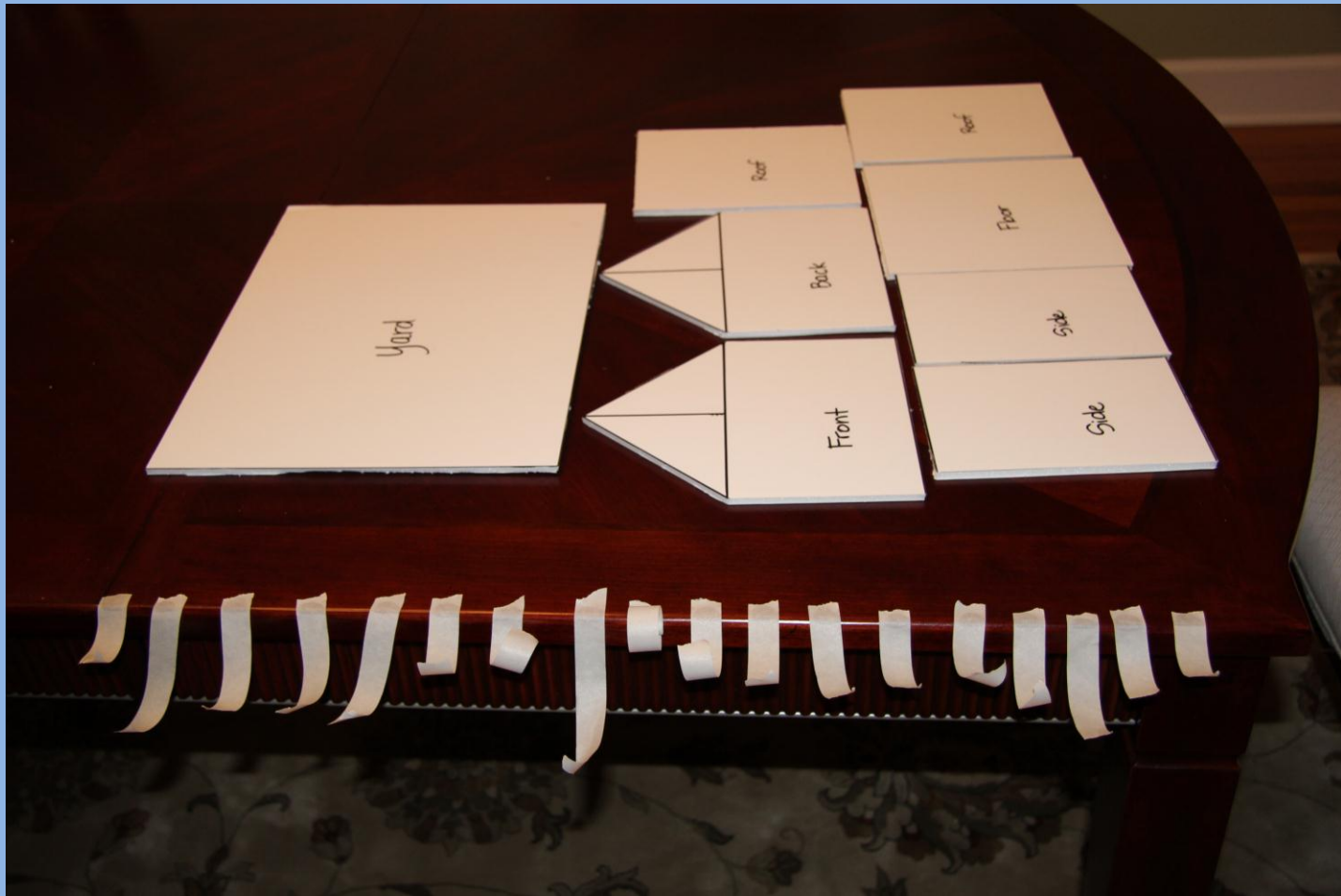

Attach the floor to the yard with tape.



Place the back and front pieces on TOP
of the floor.

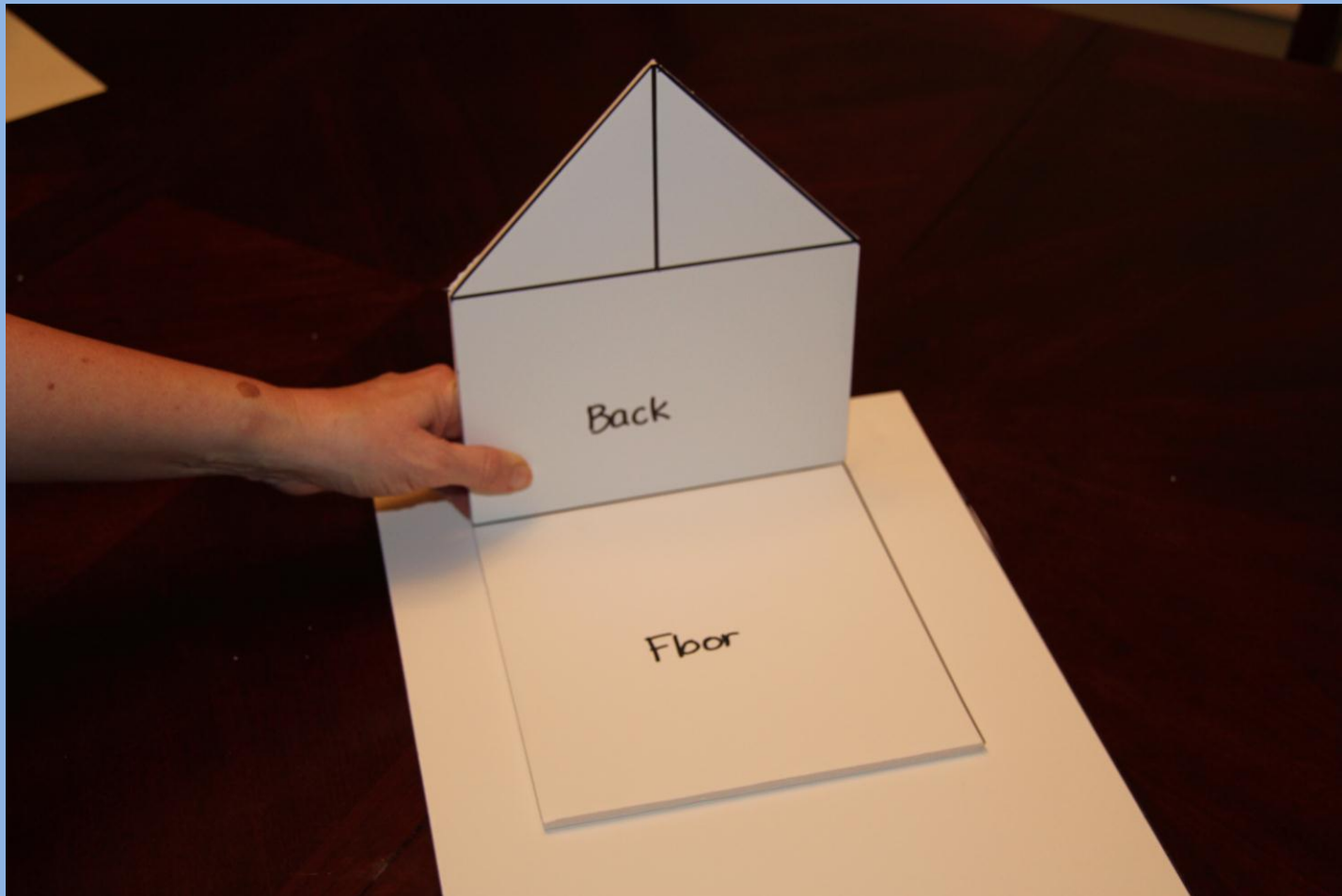

Tape the back to the floor.



Tape the front to the floor.

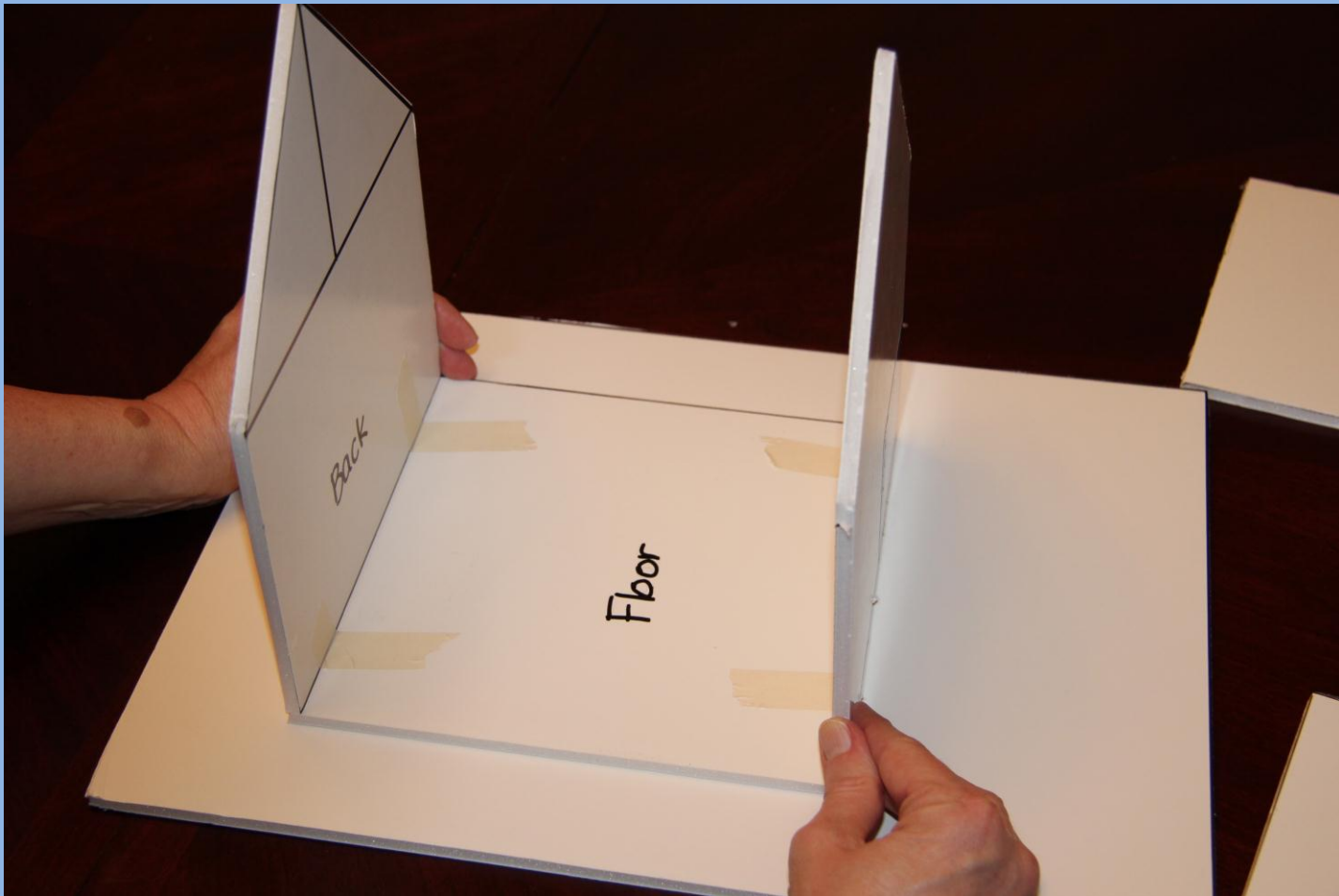

Add the side piece and secure with tape.



Here is a look at the inside of the house.

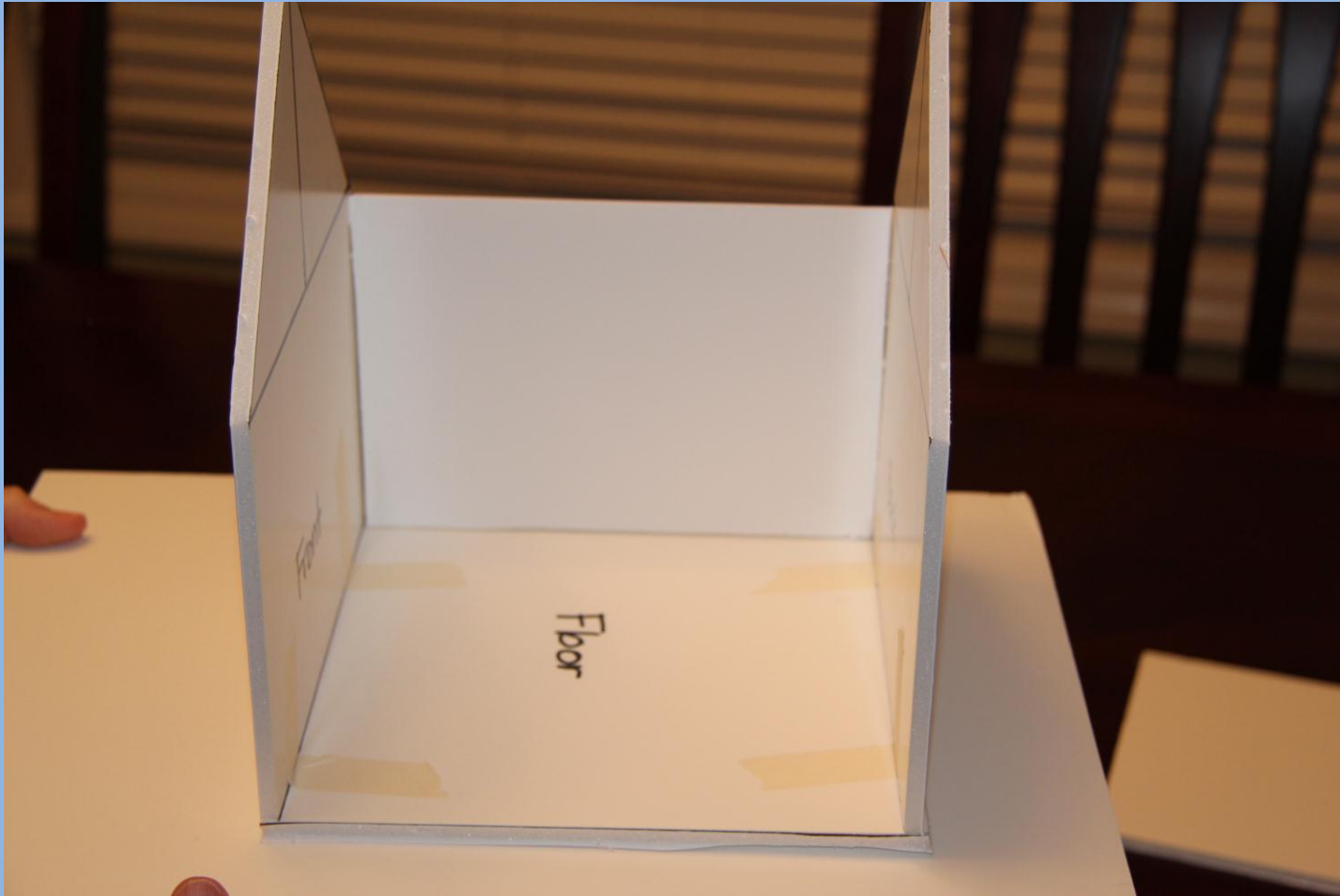

Add the other side.

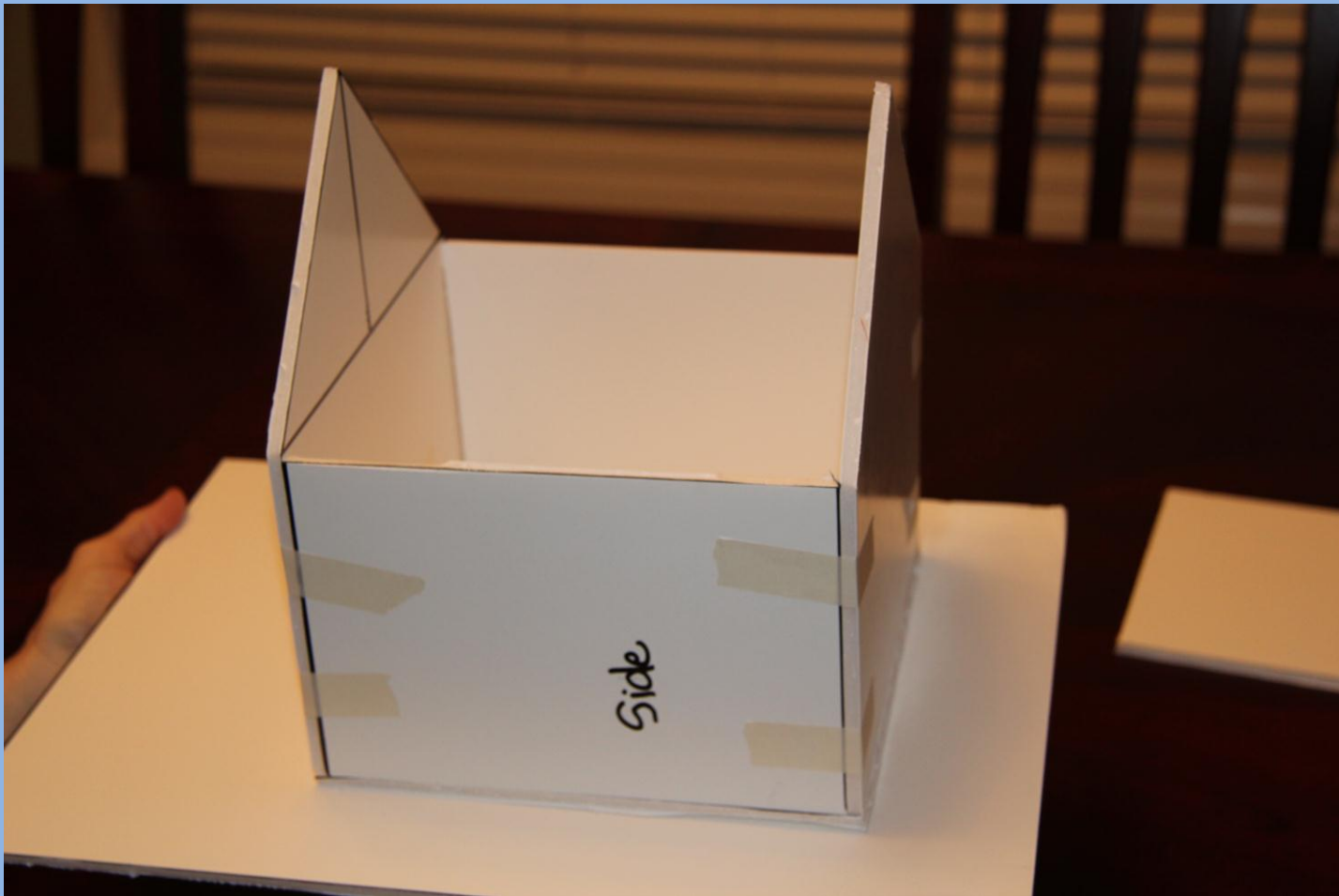

Attach the roof to the house.



Top view of the house



Finished view of the front or back. You decide where you want the front of the house to be.



Side view of the completed house

